

# Using the LXE Single-Band Headset

**LXE**<sup>®</sup>

Part No. HX1501HEADSET

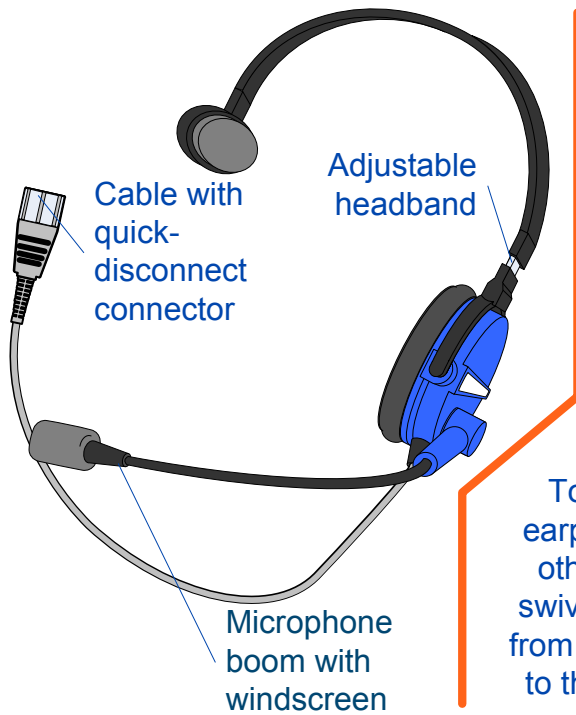

## 1 Adjusting headset to fit you

Adjust headband to fit

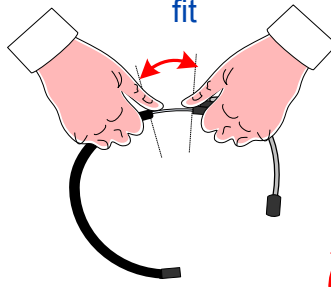

CAREFULLY bend headband to fit you

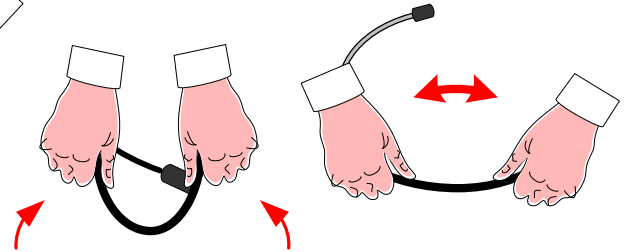

To wear earpiece on other ear, swivel boom from one side to the other

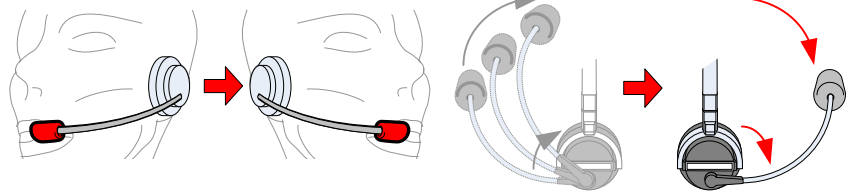

## 2 Positioning microphone

2A

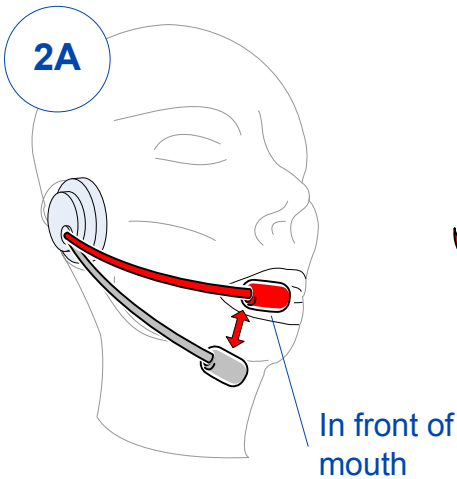

2B

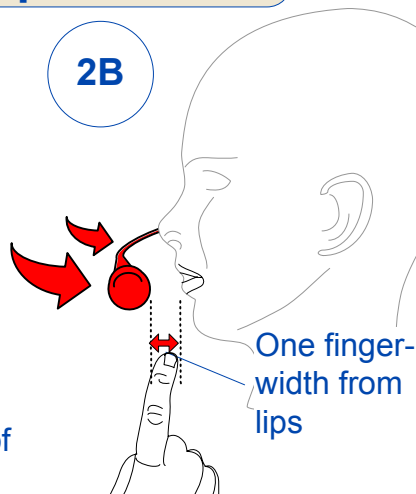

2C

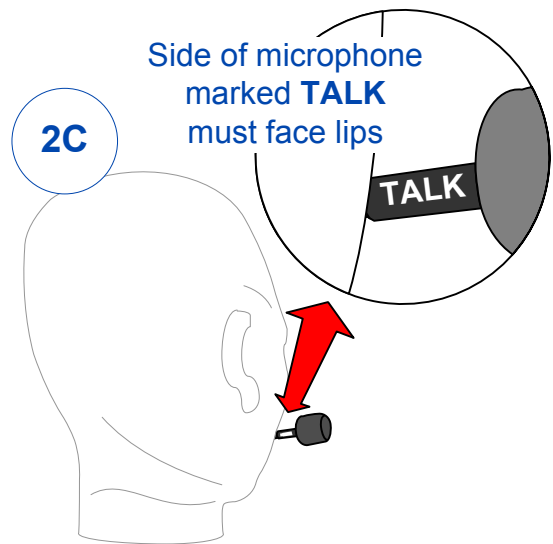

## 3 Connecting to client unit

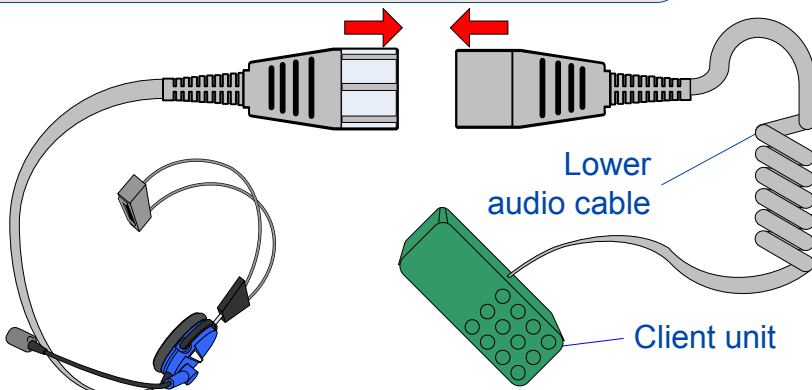

## 4 Replacing earpiece pads

If earpiece pad gets worn, pull it off and replace it with a new one

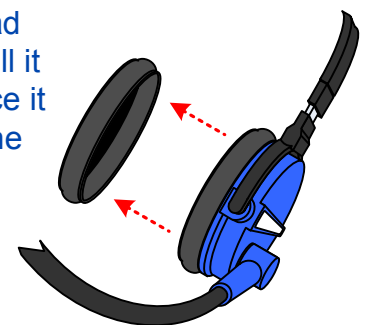

## 5 Wearing audio cable

### UNDER CLOTHING (recommended)

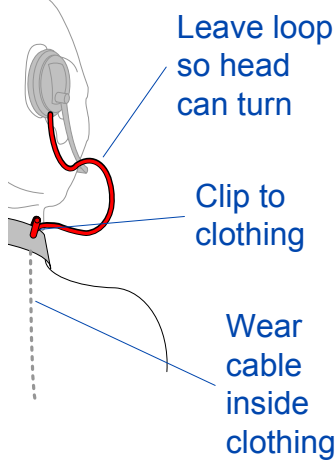

OR

### OVER CLOTHING (with cable in back)

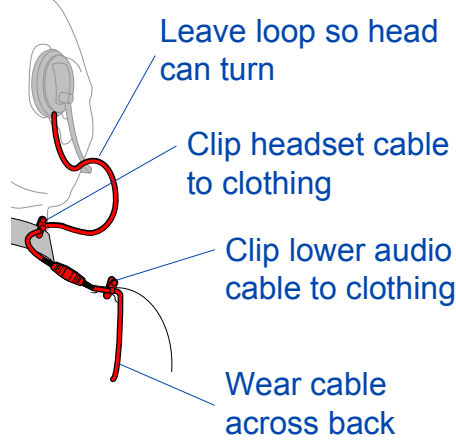

**Do not wear cable in front of body**



Attach cables securely to clothing so they let you work without restriction and cannot get tangled in something.

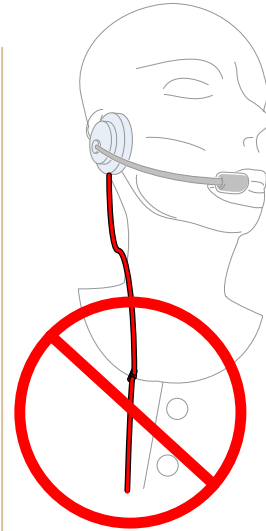

## 6 Caring for the headset

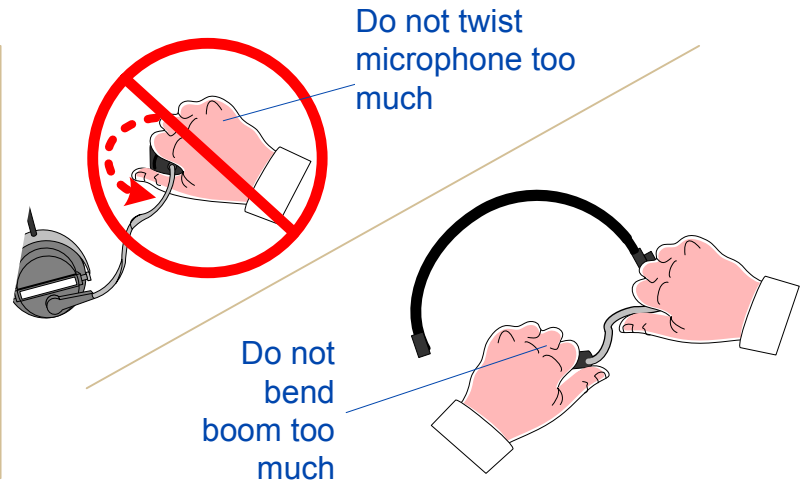
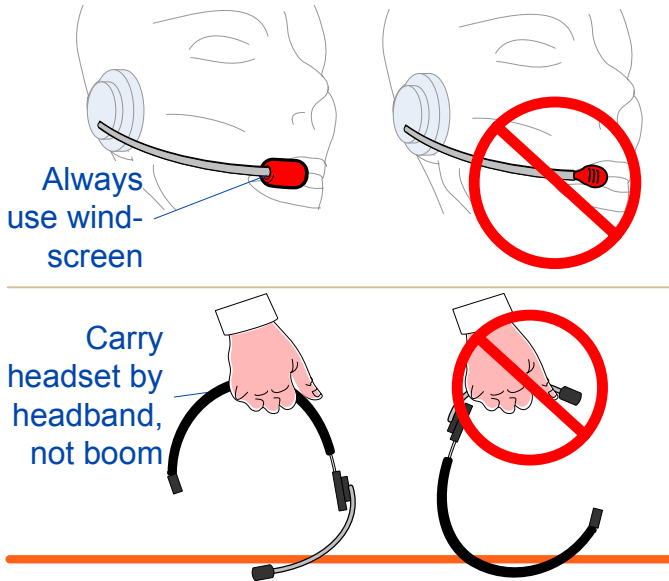

## 7 In harsh environments

Every four hours, or when windscreen gets moist or frozen, replace windscreen

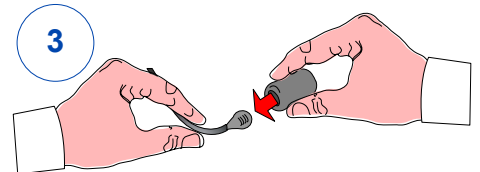
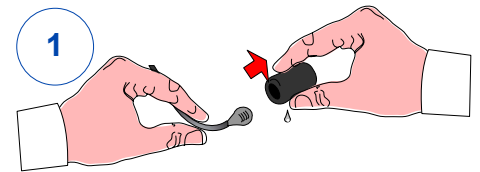
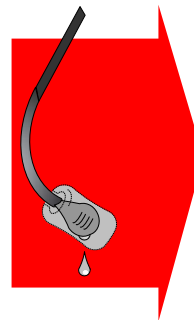
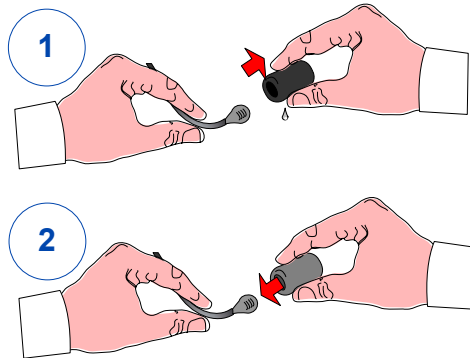
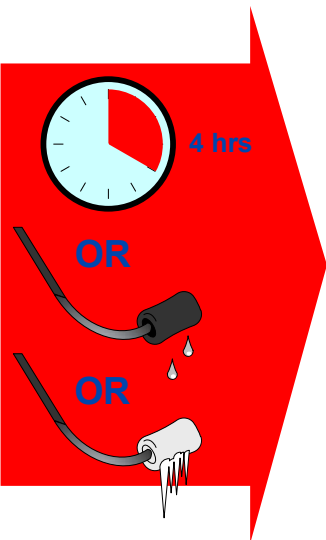

Do not squeeze wet windscreen while on boom

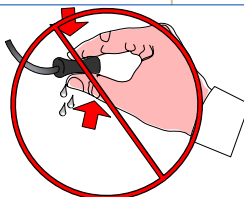

If the microphone stops working, it might be too wet. Try removing the windscreen, shaking moisture out of the microphone, and replacing the windscreen with a dry one