

Using the LXE Dual-Ear Wireframe Behind-the-Neck Headset

Part No. HX3601HEADSET

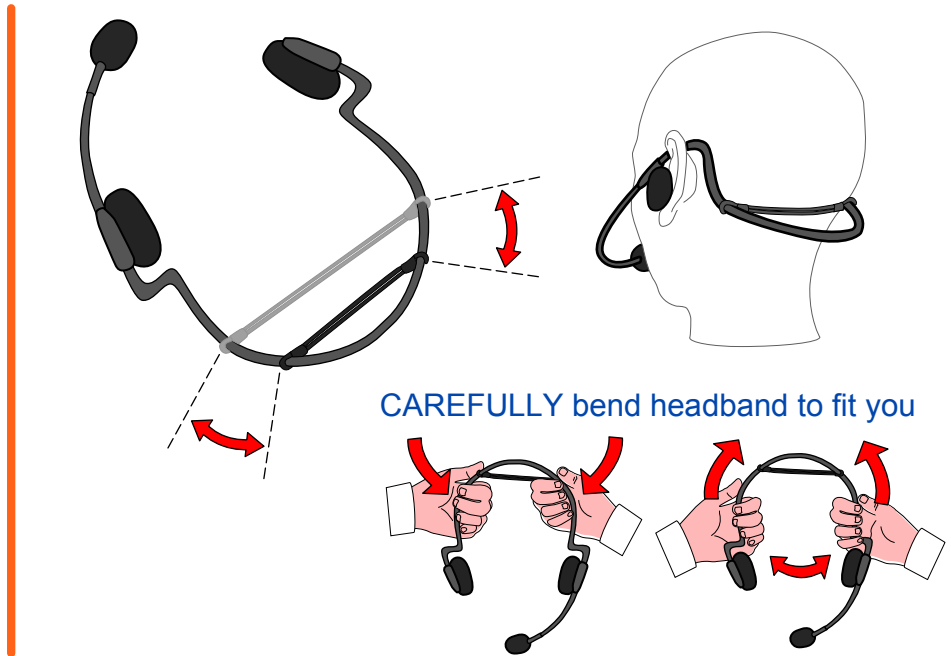

1 Adjusting to fit you

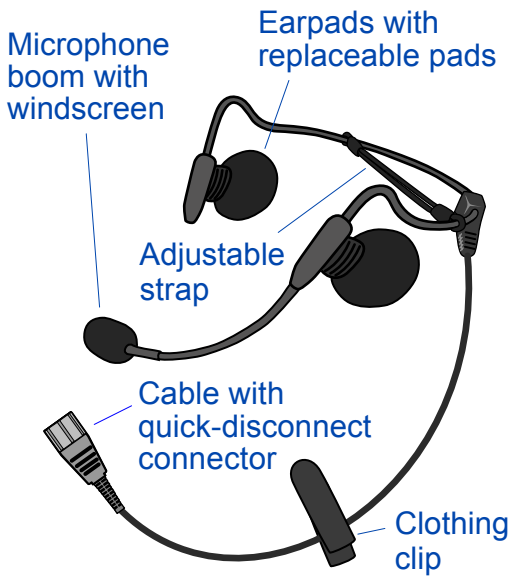

2 Positioning microphone

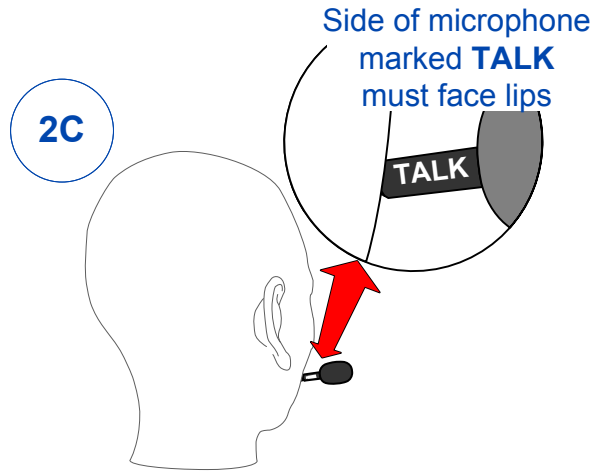
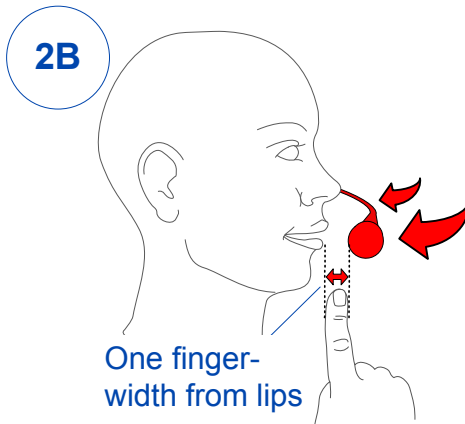
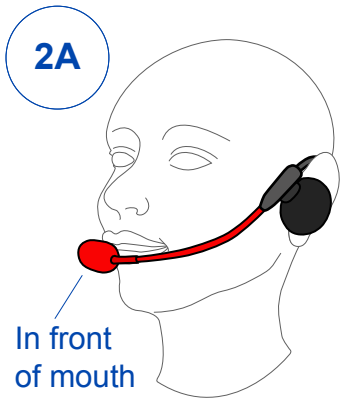

3 Connecting to client unit

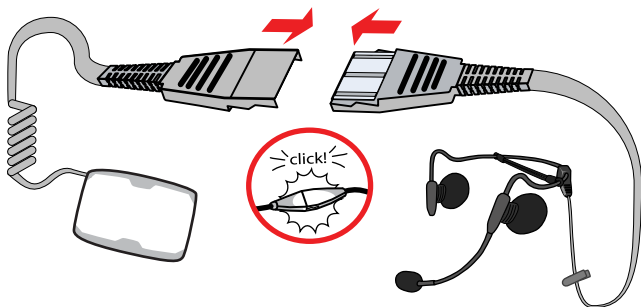

4 Replacing earpads and strap

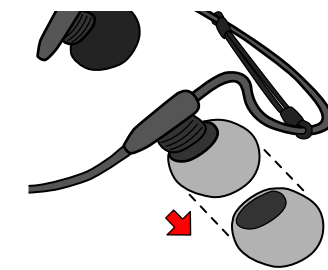

If earpiece pad gets worn, pull it off and replace it with a new one

If strap gets worn, pull it off and replace it with a new one

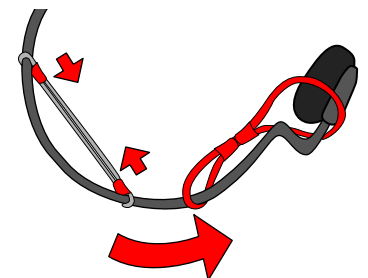

5 Wearing audio cable

UNDER CLOTHING
(recommended)

Clip to clothing

Leave loop so head can turn

Wear cable inside clothing

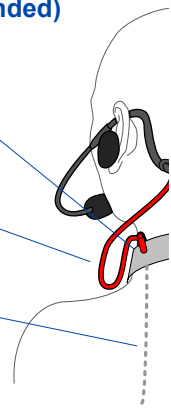

OR

OVER CLOTHING
(with cable in back)

Clip headset cable to clothing

Leave loop so head can turn

Clip lower audio cable to clothing

Wear cable across back



Do not wear cable in front of body

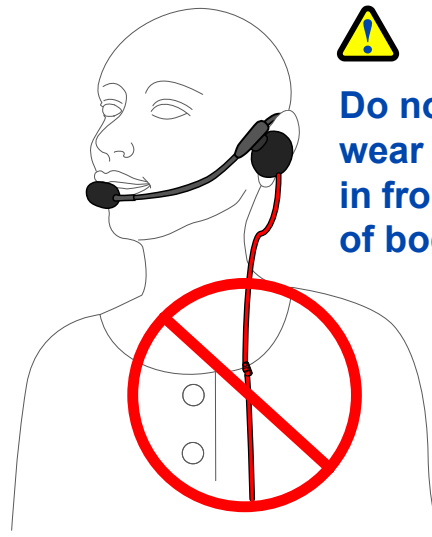

Attach cables securely to clothing so they let you work without restriction and cannot get tangled in something.

6 Caring for the headset

Always use windscreen

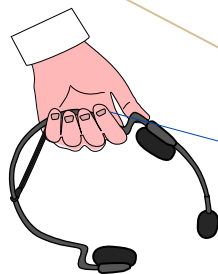

Carry headset by headband, not boom

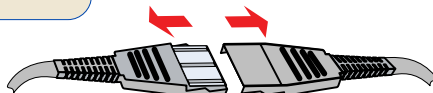

When disconnecting, pull the connectors apart

Do not snap them

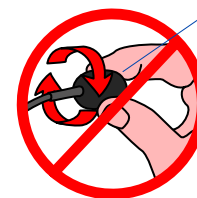
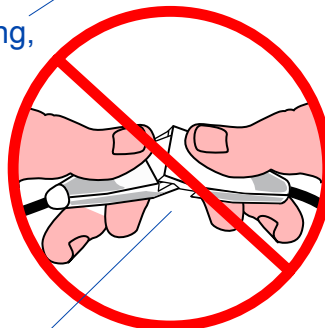

Do not twist microphone too much



Do not bend boom too much

7 In freezer environments

Every four hours, or when windscreen gets moist or frozen, replace windscreen

If the microphone stops working, it might be too wet. Try removing the windscreen, shaking moisture out of the microphone, and replacing the windscreen with a dry one

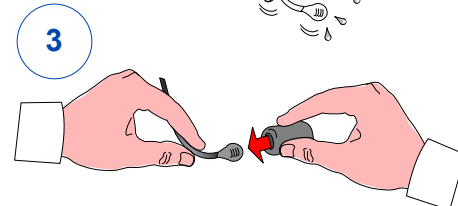
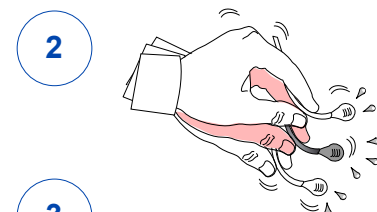
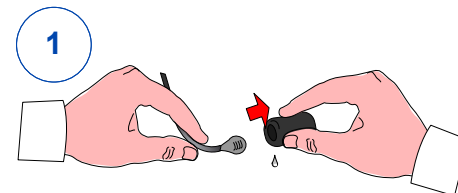
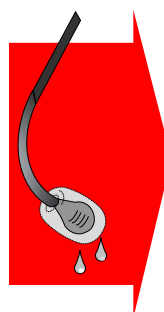
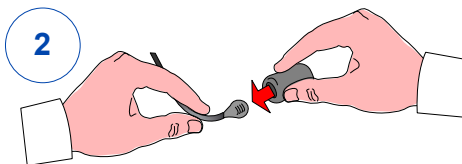
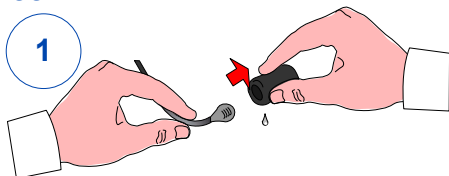
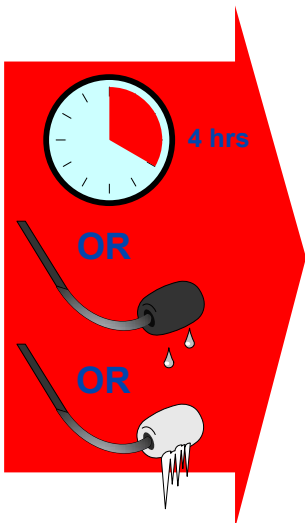

Do not squeeze wet windscreen while on boom

