

Using the LXE Ruggedized Headset

Part No. HX3602HEADSET

LXE[®]

1 Adjusting headset to fit you



Adjust to fit you

CAREFULLY bend headbands to fit you

To wear earpiece on other ear,

swivel boom from one side to the other...

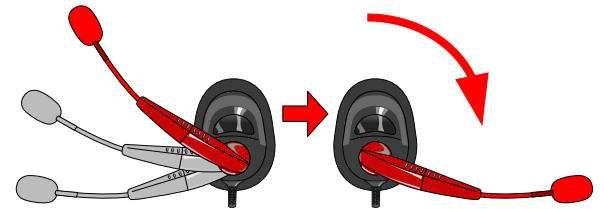

...and swivel earpiece to fit

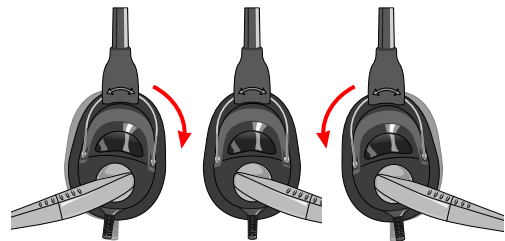

2 Connecting to client unit

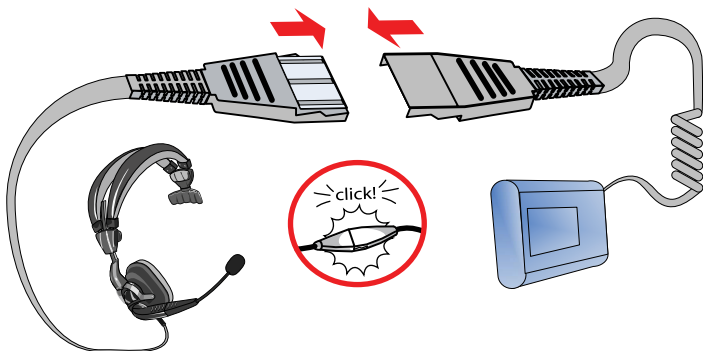

3 Positioning microphone

2A

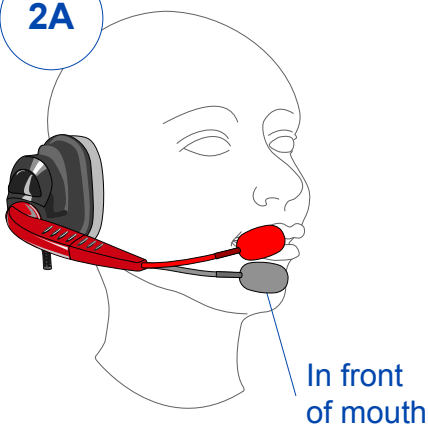

2B

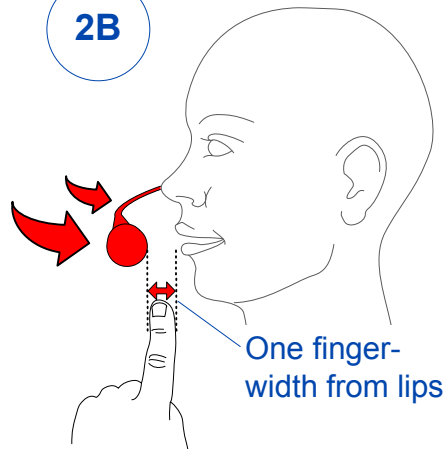

2C

Side of microphone marked **TALK** must face lips

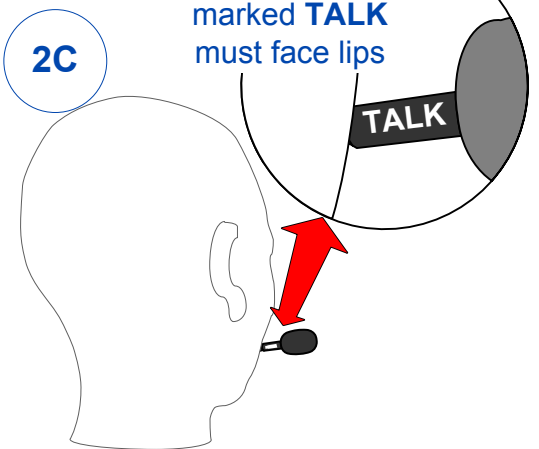

4 Wearing audio cable

UNDER CLOTHING
(recommended)

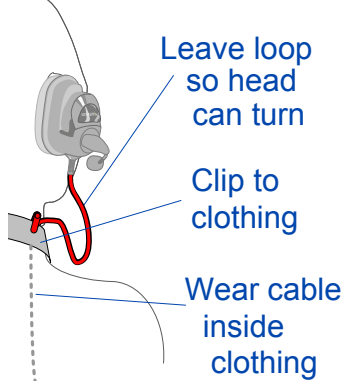

OR

OVER CLOTHING
(with cable in back)

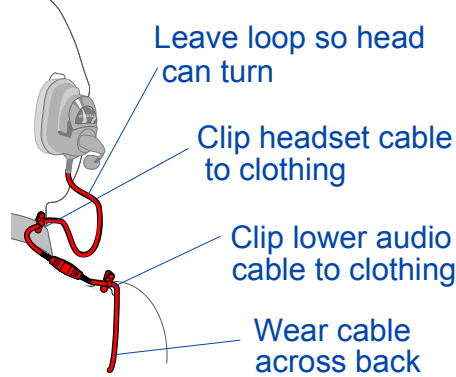

 Attach cables securely to clothing so they let you work without restriction and cannot get tangled in something.

5 Caring for the headset

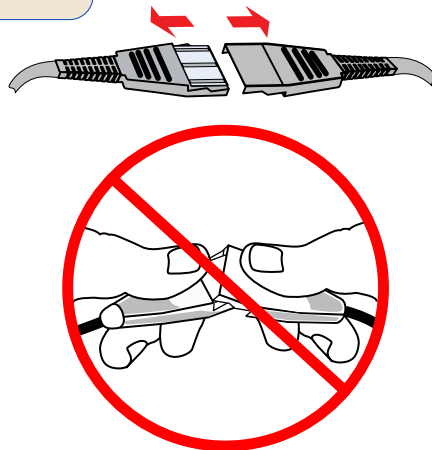
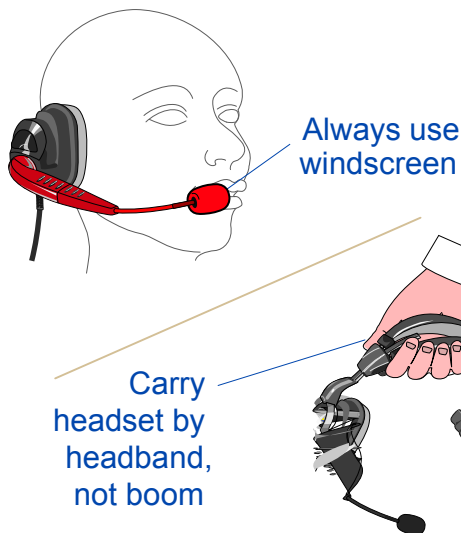

6 In freezer environments

Every four hours, or when windscreen gets moist or frozen, replace windscreen

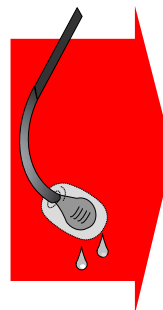
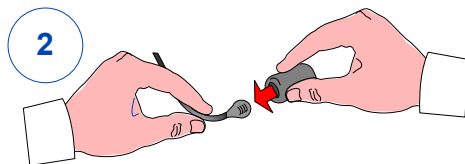
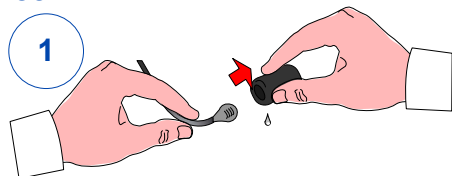
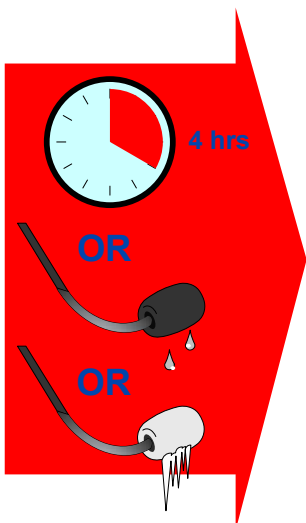

Do not squeeze wet windscreen while on boom



If the microphone stops working, it might be too wet. Try removing the windscreen, shaking moisture out of the microphone, and replacing the windscreen with a dry one

