

STD-8000

Installation and Utilization Instructions



Figure 1

GENERAL FEATURES

The STD-8000 is a stand for the PowerScan® barcode readers for hands-free operation. It also provides that the reader's handle is always within the operator's reach.

The mounting kit supplied with the stand contains the following components:

- ◆ 3 self-tapping screws
- ◆ 2 adhesive strips

UTILIZATION

Insert the reader head into the stand as shown in Figure 1.

NOTE

If using a model without display, it is necessary to mount the size adapter (refer to Figures 2, 3 and 4).

Position the reader for the best orientation with respect to the barcodes by rotating the holder.

ASSEMBLING THE STD-8000

To assemble the STD-8000 proceed as follows, referring to Figure 2:

1. Connect the left and right supports ① and fix them to the central support ② with the positioning screw ③.
2. Position the assembly by screwing the central support ② into the tube ④.
3. Position the assembly onto the base by fixing the tube ④ onto the base with the fixing screw ⑤.

If using a model without display, it is necessary to mount on the holder the size adapter ⑥, composed of an internal and an external part.

NOTE

Block the size adapter internal part by inserting the two internal wings of the holder inside the holes ⑦ as shown in Figure 4.

FIXED DESKTOP USE

The STD-8000 can be mounted to any surface using either the 3 self-tapping screws or the 2 double-sided adhesive strips.

Refer to Figure 2 while proceeding as follows:

Mounting with screws:

1. Be sure that the STD-8000 is already assembled.
2. Fix the STD-8000 base to the desired surface by means of the three self-tapping screws ⑧.

Mounting with adhesive strips:

1. Carefully clean the bottom surface of the base with alcohol to remove any impurities that could reduce the adhesion.
2. Remove the protective plastic from one side of the adhesive strips ⑨ and stick them onto the bottom surface of the base.
3. Remove the plastic from the other side of the strips and affix the STD-8000 to the desired surface.

NOTE

The surface must be smooth and clean to allow a correct adhesion.

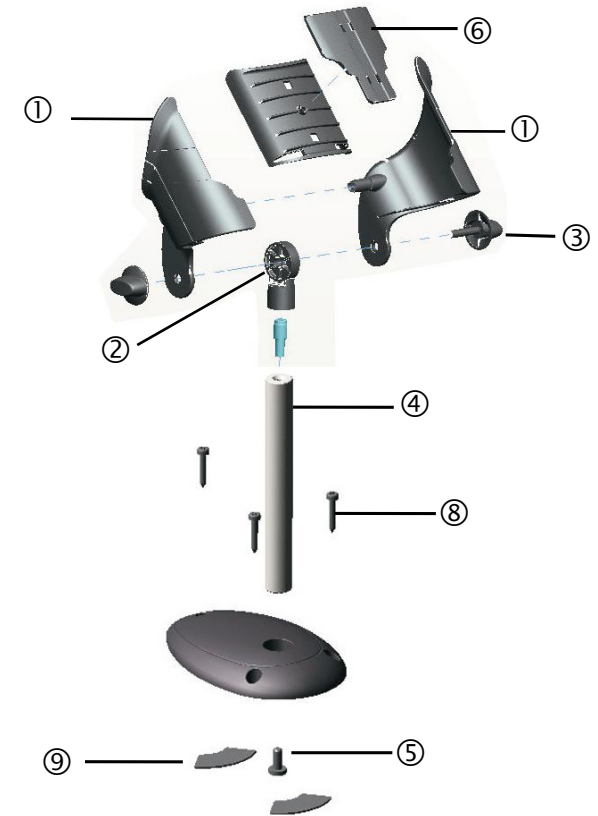

Figure 2



Figure 3



Figure 4